

Features

- Double stage filter
- Rated up to 100A
- Superior Performance
- Chassis mounting

Applications

- Power Systems
- Electronic Equipment
- Frequency convertors
- UPS/Inverters

Typical Circuit Diagram

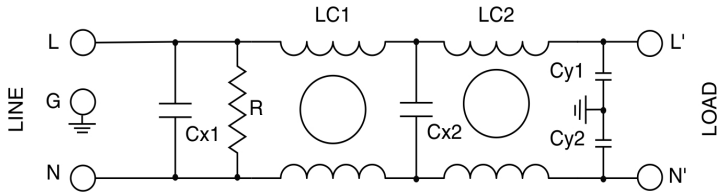

Typical Circuit Diagram (Medical Version)

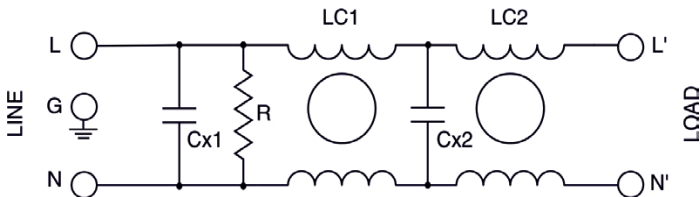

Performance Indicator

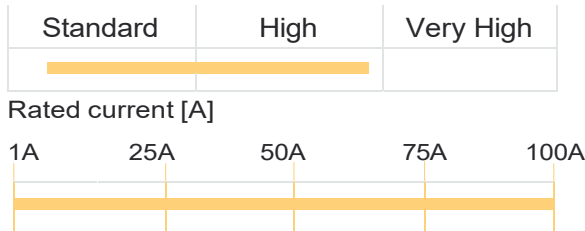



Approvals & Compliances





Technical Specifications

Maximum Continuous Operating Voltage	250VAC, 50/60Hz(UL Approval) 250VDC
Operating Frequency	DC to 400Hz
Current ratings	1A to 100A @40°C
High Potential test voltage	L to G 2250VDC for 1 Minute L to L 1450VDC for 1 Minute
Overload Capability	135% of Rated current for 15 minutes
Design Corresponding to	UL 60939-3, CSA 22.2 No.8-13 and IEC 60939-1&2
Flammability corresponding to	UL 94 V-0
Temperature range	-25°C to +85°C
Climatic Category	25/85/21

Selection Table

Available Part Number	Rated Current @40°C	Leakage Current (mA) @250VAC	Termination		Weight (Grams)
					
AMI-1660-1-1	1A	0.34	6.3 x 0.8		120
AMI-1660-2-1	2A	0.34	6.3 x 0.8		120
AMI-1660-3-1	3A	0.34	6.3 x 0.8		170
AMI-1660-6-1	6A	0.34	6.3 x 0.8		170
AMI-1660-10-1	10A	0.34	6.3 x 0.8		170
AMI-1660-15-1	15A	0.34	6.3 x 0.8		200
AMI-1660-20-M5	20A	0.73		M5	650
AMI-1660-25-M5	25A	0.73		M5	650
AMI-1660-30-M5	30A	0.73		M5	650
AMI-1660-35-M5	35A	0.73		M5	1000
AMI-1660-40-M5	40A	0.73		M5	1000
AMI-1660-50-M6	50A	0.73		M6	2000
AMI-1660-60-M6	60A	0.73		M6	2000
AMI-1660-100-M8	100A	0.73		M8	2000

Selection Table/Medical Version

Available Part Number	Rated Current @40°C	Leakage Current @250VAC/50Hz (µA)	Termination		Weight (g)
					
AMI-1660B-1-1	1A	5	6.3 x 0.8		120
AMI-1660B-2-1	2A	5	6.3 x 0.8		120
AMI-1660B-3-1	3A	5	6.3 x 0.8		170
AMI-1660B-6-1	6A	5	6.3 x 0.8		170
AMI-1660B-10-1	10A	5	6.3 x 0.8		170
AMI-1660B-15-1	15A	5	6.3 x 0.8		200
AMI-1660B-20-M5	20A	5		M5	650
AMI-1660B-25-M5	25A	5		M5	650
AMI-1660B-30-M5	30A	5		M5	650
AMI-1660B-35-M5	35A	5		M5	1000
AMI-1660B-40-M5	40A	5		M5	1000
AMI-1660B-50-M6	50A	5		M6	2000
AMI-1660B-60-M6	60A	5		M6	2000
AMI-1660B-100-M8	100A	5		M8	2000

Mechanical Drawing

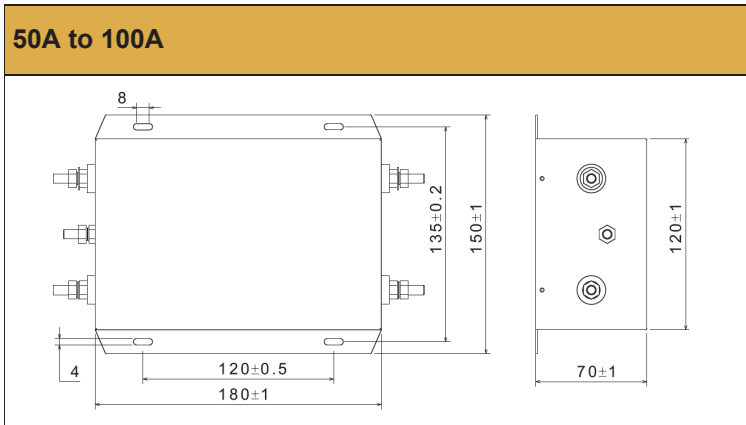
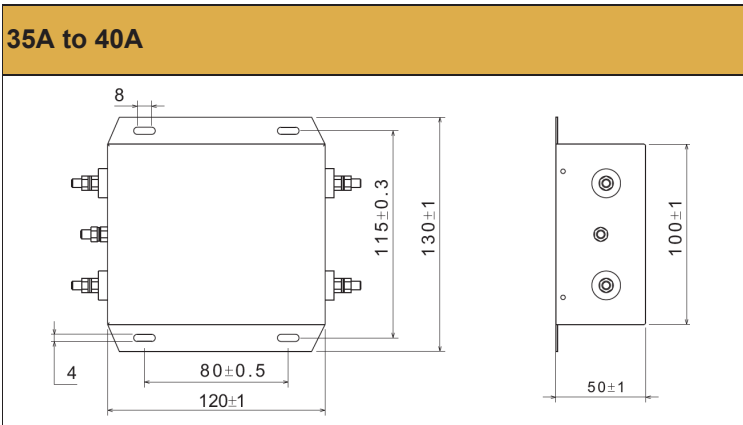
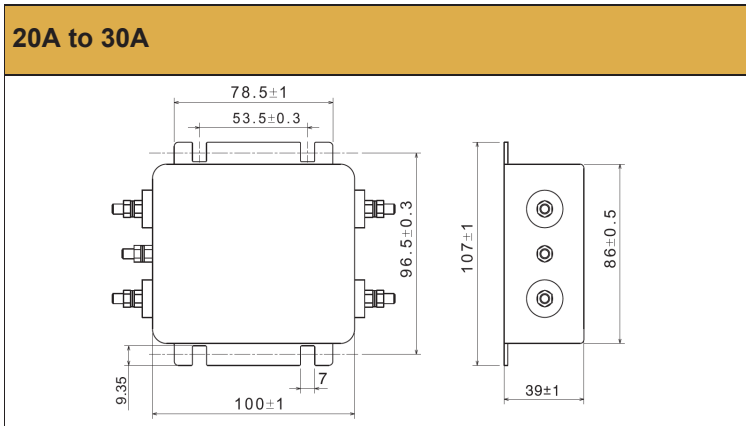
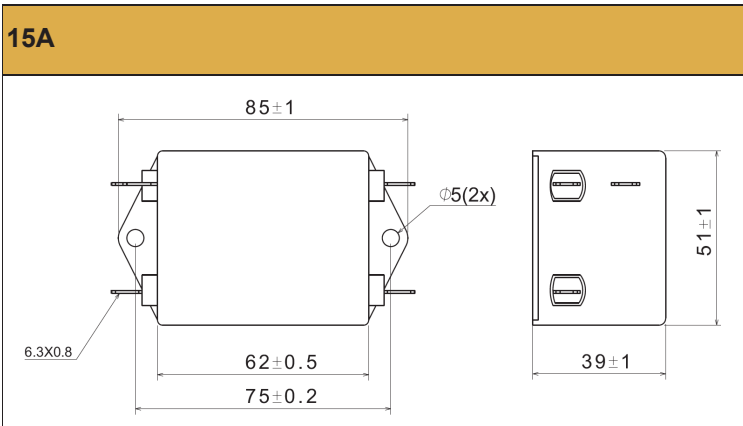
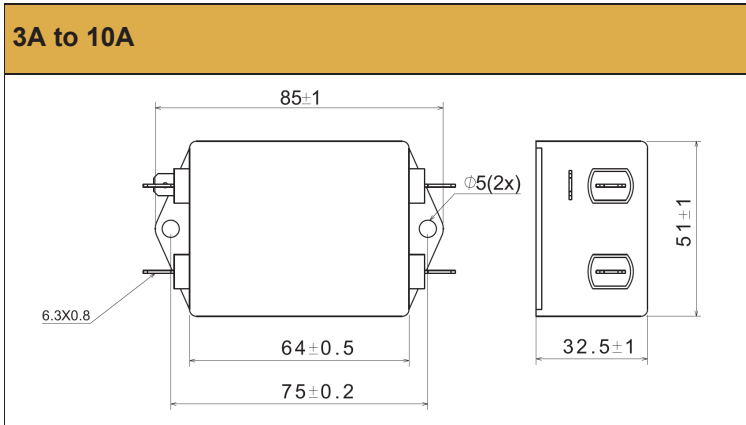
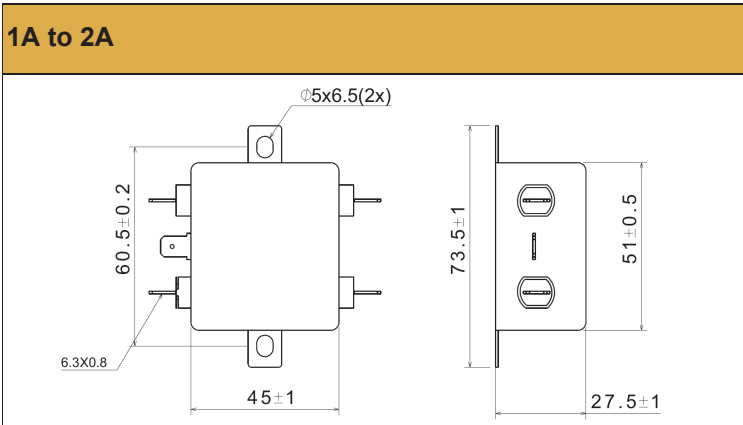

Thread Size	M5	M6	M8	M10
Recommended Torque (Nm)	2-2.2	3.5-4	8-9	15-17
Earth Terminal (Nm)	2-2.2	3.5-4	8-9	15-17

Typical Insertion Loss

According to CISPR17 in 50 Ω system

— Common Mode / Asymmetrical (L-G)
 — Differential Mode / Symmetrical (L-L)

1A

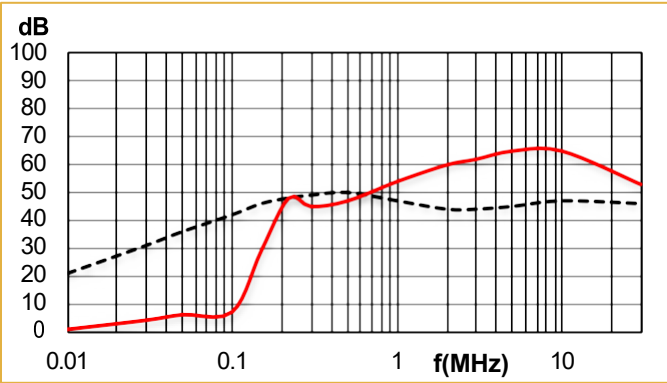

3A

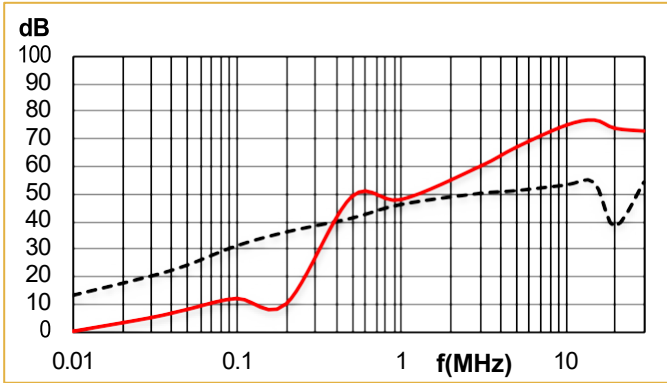

6A

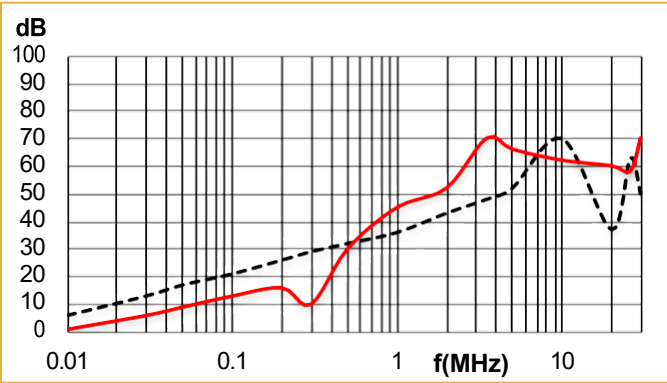

10A

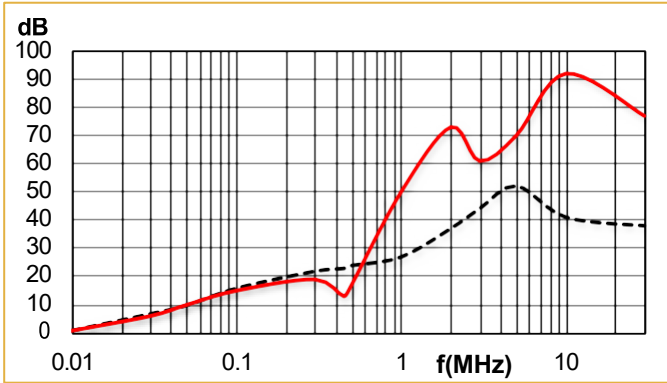

15A

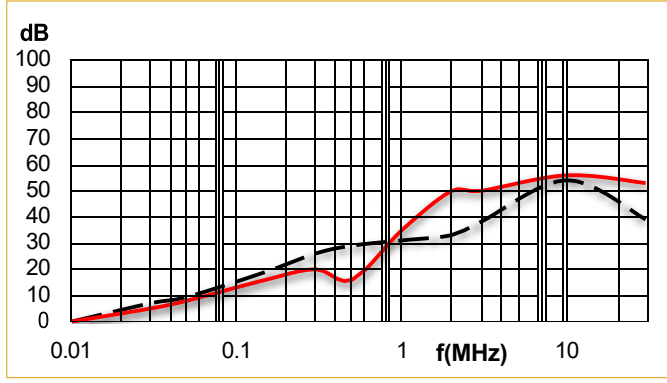

20A

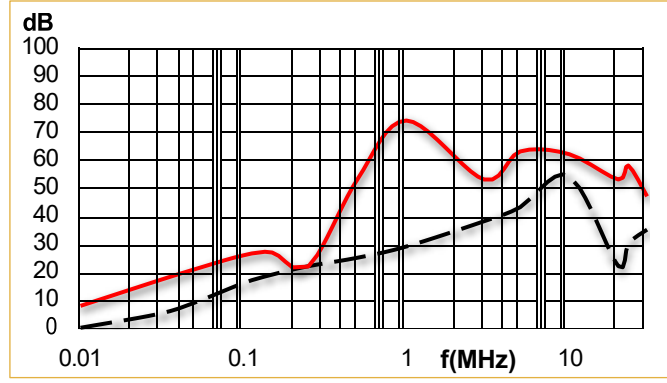

Typical Insertion Loss

According to CISPR17 in 50 Ω system

— Common Mode / Asymmetrical (L-G)
 — Differential Mode / Symmetrical (L-L)

30A

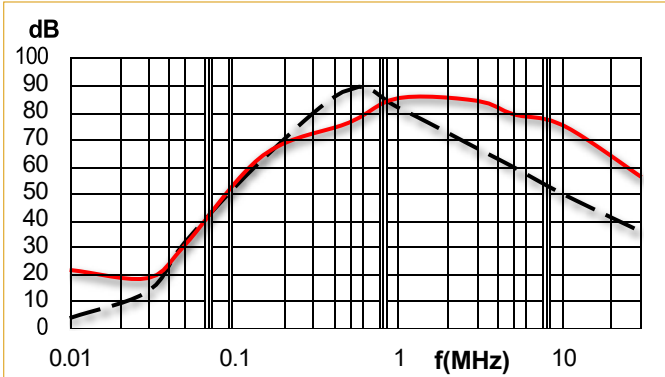

40A

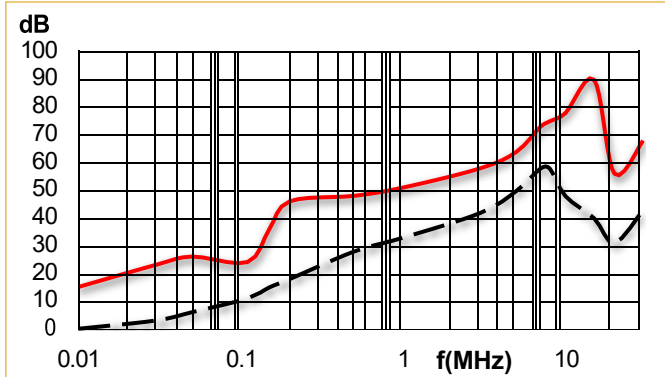

50A to 100A

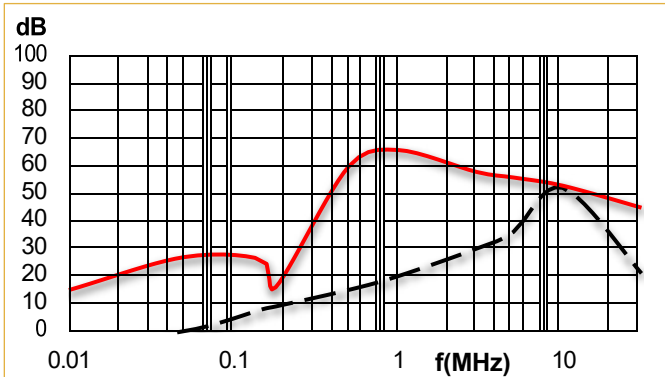

Typical Insertion Loss

(Medical Version)

According to CISPR17 in 50 Ω system

— Common Mode / Asymmetrical (L-G)
 — Differential Mode / Symmetrical (L-L)

1A

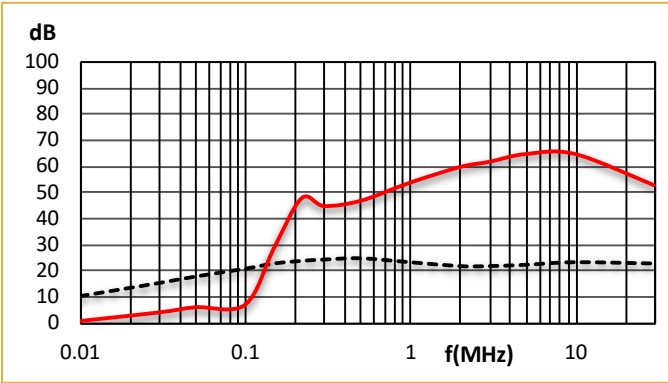

2A

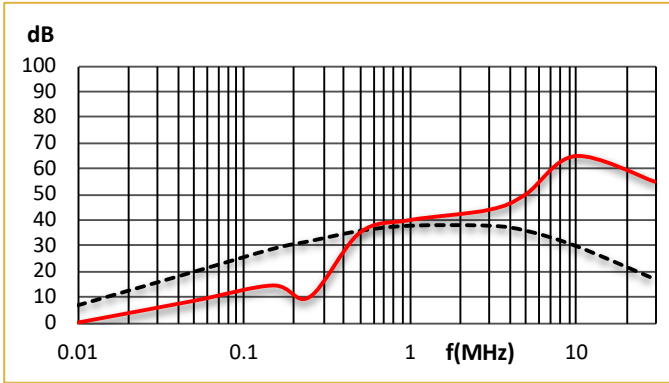

3A

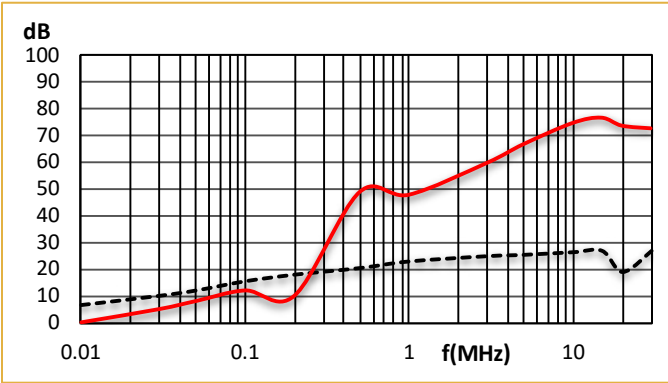

6A

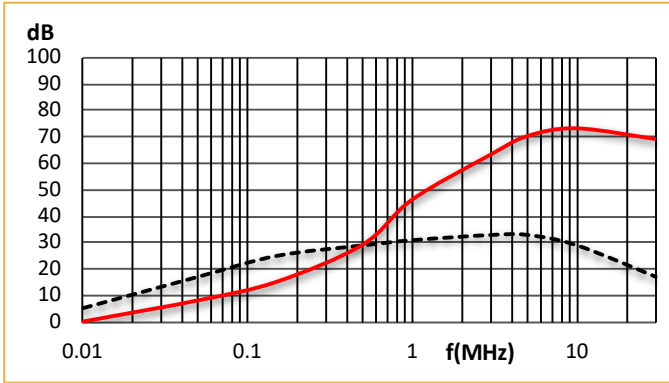

10A

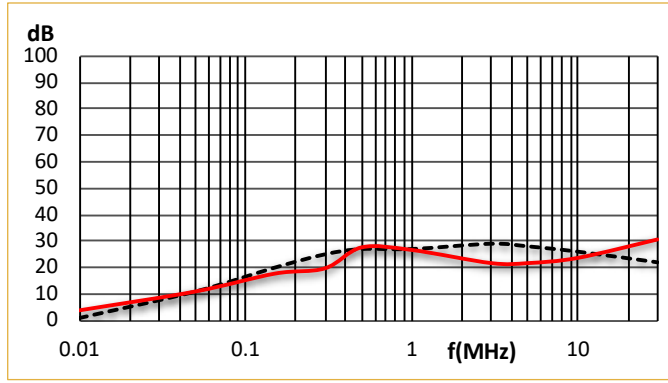

15A

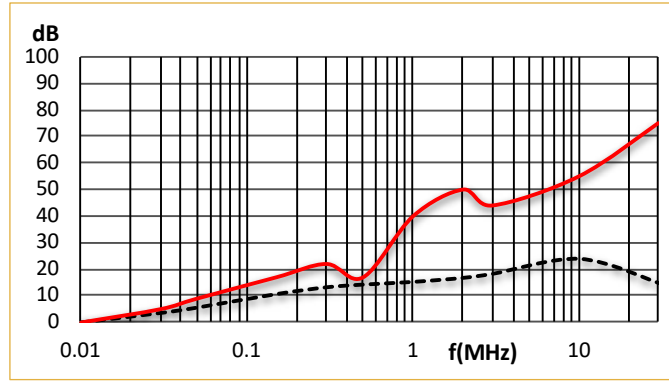

Typical Insertion Loss

(Medical Version)

According to CISPR17 in 50 Ω system

— Common Mode / Asymmetrical (L-G)
 — Differential Mode / Symmetrical (L-L)

20A

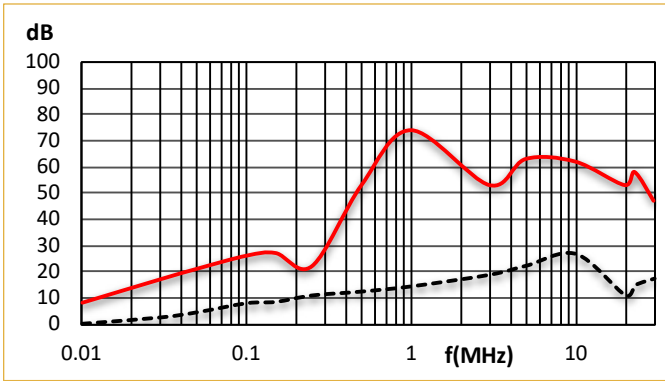

30A

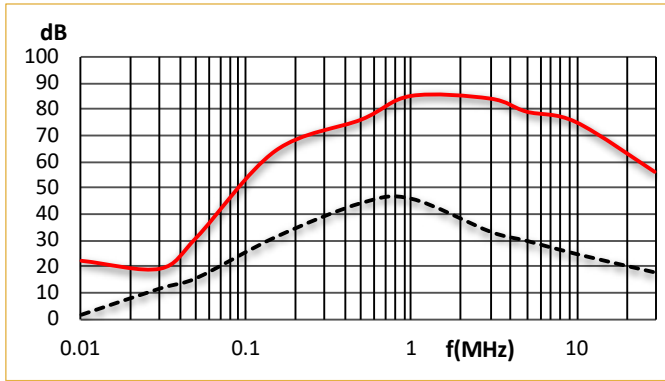

40A

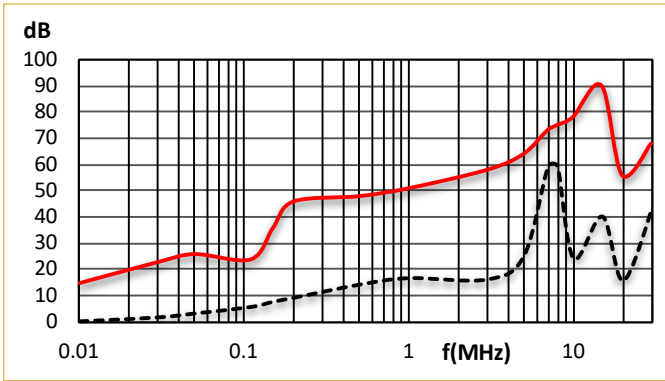

50A to 100A

