

P-105 SERIES PHOTOCELL

P-105 Series is a button photocell design primarily used for mounting and internal post applications. Ideal for wall mounting and decorative lighting for both commercial and residential applications. All 105 series are constructed from high impact weather resistant UV stabilized polycarbonate housing with some models available with wall mounting options, 180 Joule MOV for transient surge protection as well as a high ambient temperature photo control option for running in HID luminaires.

Product Features:

- Turn ON Fc : 1.5
- Rear Wire Leads
- 3/4" Long Threaded Nipple
- Ideal for Compact Spaces
- 30-45 Second Time Delay
- 1200 and 1800 W Load Rating
- Wall Plate Design Option Available
- Fail Safe
- High Ambient Option Available
- ANSI C136.10 Compliant
- OFF/ON Ratio 4:1
- UL/CSA Listed (CUL)
- Design Life at Rated Load: 7,500 Cycles (20 years)
- 10 Year Product Warranty



Specifications:

Physical

Enclosure: Designed to meet ANSI C136.24 & UL 773A
Power Consumption: Less than 0.9Watts (avg.) at 120VAC

Control

SPST Thermal Bi-metal Switch

Temperature Range

-40°F to 158°F (-40°C to +70°C) at 96% RH

Light Sensor

Cadmium Sulfide Cell

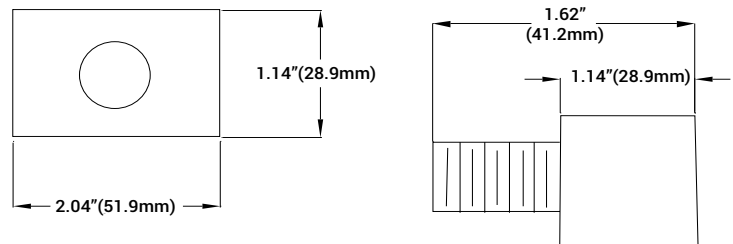

P-105 Series Product Selection Information

XXX - Denotes Optional Customer Number

| Model | AMI P-105-01-6-XXX | AMI P-105-03-6-XXX | AMI P-105-01-6-WP-XXX | AMI P-105-03-6-WP-XXX | AMI P-105-03-15-XXX | AMI P-105-01-6-HA-XXX | AMI P-105-01-15-XXX |
|------------------------------|--------------------|--------------------|-----------------------|-----------------------|---------------------|-----------------------|---------------------|
| Rated Volts (VAC) | 120 | 208/240/277 | 120 | 208/240/277 | 208/240/277 | 120 | 120 |
| Voltage Range (Volts) | 105-130 | 185-305 | 105-130 | 185-305 | 185-305 | 105-130 | 105-130 |
| Load Rating Tungsten (Watts) | 1800 | 1200 | 1800 | 1200 | 1200 | 1800 | 1800 |
| Load Rating Ballast (VA) | 1100 | 1100 | 1100 | 1100 | 1100 | 1100 | 1100 |

P-105 Series Technical Data

| Voltage Range | Fail Mode | Housing | Lead Wires | Nipple | Nut | Surge Protection |
|---------------|-------------------------------|---|--|-----------|--------------------------|------------------|
| 105 - 305 VAC | ON (contacts normally closed) | Polycarbonate with UV stabilized window | 6", #18 AWG, 105°C or 6", #18 AWG, 150°C or 15" or #18 AWG, 105°C (depending on model) | 3/8" pipe | 3/8" pipe, thermoplastic | 180J |