

E8 SERIES PHOTOCELL - LED LIGHTING COMPATIBLE

E8 series photocells are specifically designed for 20 years operation, withstanding heat and weather conditions with a multi-volt operation. FR4 glass epoxy, which forms the primary insulating backbone of printed circuit boards, ensures higher levels of ON/OFF operation cycles.

Product Features:

- High Temperature Resistant Housing
- Double-Sided Glass Epoxy FR4 Circuit Board
- 5000 Hours at 105°C.
- Interlock Design
- Design Life at Rated Load: 20,000 Cycles (20+ years)
- Multi-Volt Operation
- Meets or Exceeds ANSI C136.10
- Improved Durability
- UL/CSA Listed (CUL)
- RoHS Compliant
- 10 Year Product Warranty

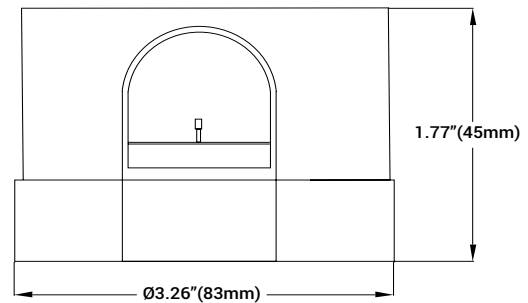

Specifications:

Physical

Enclosure: Designed to meet ANSI C136.10.
Power Consumption: Less than 0.5 Watts (avg.) at 120VAC

Temperature Range

-40°F to 158°F (-40°C to +70°C) at 96% RH

Light Sensor

Non-drifting photo transistor

Relay Rating

30 Amp general purpose relay.

Load Rating

1000 Watt Tungsten, 1800 VA Ballast

Cover

High impact polypropylene with UV stabilized polycarbonate window

Base

High temperature polyester (PBT)

Connection

3-pole locking type with solid brass blades

Gasket

Cross-linked polyethylene

E8 Series Product Selection Information

IR - Denotes IR Filtered Phototransistor
XXX - Denotes Optional Customer Number

Model	AMI-E8-102-BL-XXX (IR)	AMI-E8F-102-BL-XXX (IR)
Rated Volts (VAC)	120/208/240/277	120/208/240/277
Voltage Range (Volts)	105-305	105-305

E8 Series Technical Data

Voltage Range	Frequency	ON/OFF Ratio	Time Delay ON/OFF	Operating Light Levels	Fail Mode	Surge Protection
105-305 VAC	50/60Hz	1.5:1	Instant ON, 2-5 second delay OFF	Standard 1.5 Fc ON (optional 1-3 Fc)	E8: ON E8F: OFF	300J / 20kA