

Features

- General purpose filtering
- Choice of Earth Leakage
- Rated up to 20A
- Choice of termination

Applications

- Electrical and Electronic equipment
- Consumer goods
- Home appliances
- Office equipment

Typical Circuit Diagram

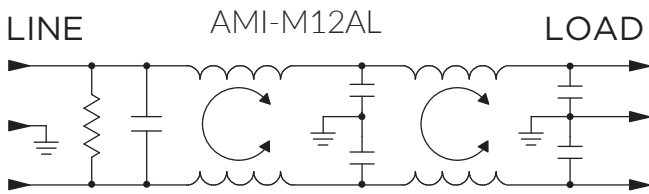
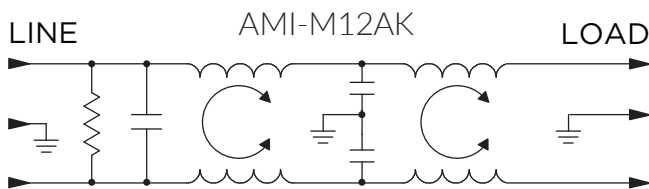

Approvals & Compliances



Technical Specifications

Maximum Continuous Operating Voltage	250 VAC Max
Operating Frequency	50/60Hz
Rated Current	1 to 20A @40°C
Temperature range	-10°C to +40°C
High Potential Test Voltage	Line to Ground: 2250 VDC Line to Line: 1450 VDC

Selection Table

AMI Designation	Input/output Style		Current Rating	Inductance mH	Capacitance		Resistor KΩ	Leakage Current @ 120 VAC 60Hz/250 VAC 50 Hz	TIL Insertion Loss	Case Style
					Cx nF	Cy pF				
Available Part Numbers	6.3mm Spade Terminals	Wire Leads	A							
AMI-M12AK-1-1-B	1	-	1	3.72	100	3270	1500	0.25mA/0.43mA	001	A
AMI-M12AK-8-1-B	-	8	1	3.72	100	3270	1500	0.25mA/0.43mA	001	C
AMI-M12AK-1-3-B	1	-	3	1.99	100	3270	1500	0.25mA/0.43mA	002	A
AMI-M12AK-8-3-B	-	8	3	1.99	100	3270	1500	0.25mA/0.43mA	002	C
AMI-M12AK-1-6-B	1	-	6	0.93	100	3270	1500	0.25mA/0.43mA	003	A
AMI-M12AK-8-6-B	-	8	6	0.93	100	3270	1500	0.25mA/0.43mA	003	C
AMI-M12AK-1-10-B	1	-	10	0.36	100	3270	1500	0.25mA/0.43mA	004	A
AMI-M12AK-8-10-B	-	8	10	0.36	100	3270	1500	0.25mA/0.43mA	004	C
AMI-M12AK-1-15-B	1	-	15	0.20	100	3270	1500	0.25mA/0.43mA	005	A
AMI-M12AK-8-15-B	-	8	15	0.20	100	3270	1500	0.25mA/0.43mA	005	C
AMI-M12AL-1-20-B	1	-	20	0.083	100	2833	1500	0.22mA/0.40mA	006	B
AMI-M12AL-8-20-B	-	8	20	0.083	100	2833	1500	0.22mA/0.40mA	006	D

Case Styles

STYLE A

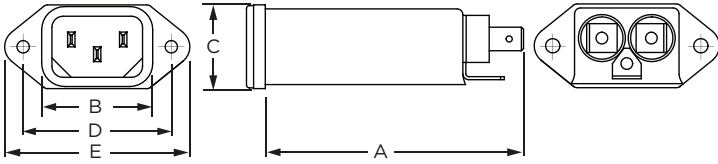

Typical Dimensions:

- Mounting holes (2): .132 [3.35] Dia. with .236 [5.99] Dia. x 90° countersink for #4 flathead screw
- Line Inlet (1): IEC 60320-1 C14
- Load Terminals (2): .250 [6.3] with .07 [1.8] Dia. hole
- Ground Terminal (1): .250 [6.3] with .07 x .16 [1.8 x 3.8] slot

STYLE B

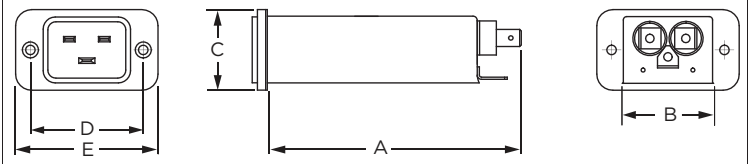

Typical Dimensions:

- Mounting holes (2): .126 [3.20] Dia. with .236 [5.99] Dia. x 90° countersink for #4 flathead screw
- Line Inlet (1): IEC 60320-1 C20
- Load Terminals (2): .250 [6.3] with .07 [1.8] Dia. hole
- Ground Terminal (1): .250 [6.3] with .07 x .16 [1.8 x 3.8] slot

STYLE C

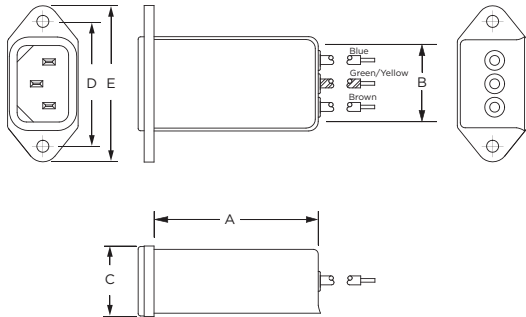

Typical Dimensions:

- Mounting holes (2): .132 [3.35] Dia. with .236 [5.99] Dia. x 90° countersink for #4 flathead screw
- Line Inlet (1): IEC 60320-1 C14
- Wire Leads: 4.0 [101.6] Min., 18AWG, UL1015

STYLE D

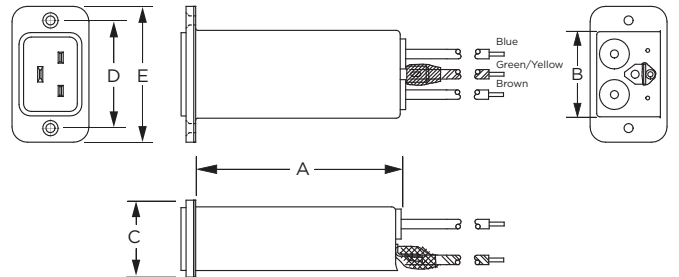

Typical Dimensions:

- Mounting holes (2): .126 [3.20] Dia. with .236 [5.99] Dia. x 90° countersink for #4 flathead screw
- Line Inlet (1): IEC 60320-1 C20
- Wire Leads: 4.0 [101.6] Min., 14AWG, UL1015

Recommended Panel Cutouts

1 to 15A

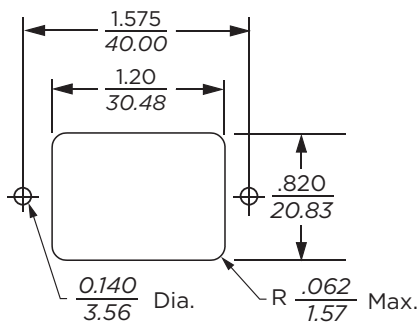

Front Mount Only
Tolerance ± 0.005 [.13]

20A

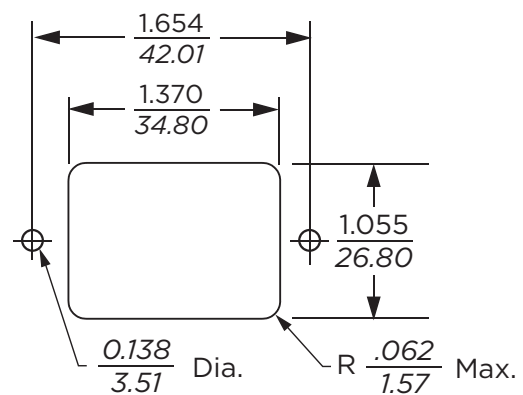

Case Dimensions:

Model Number	A max	B max	C max	D $\pm_{\pm.38}^{.015}$	E max
AMI-M12AK-1-X-B	2.7"/69.6mm	1.19"/30.2mm	0.875"/22.2mm	1.575"/40.0mm	1.98"/50.3mm
AMI-M12AK-8-X-B	2.1"/53.3mm	1.19"/30.2mm	0.875"/22.2mm	1.575"/40.0mm	1.98"/50.3mm
AMI-M12AL-20-B	3.38"/96.52mm	1.35"/34.29mm	1.18"/29.99mm	1.654"/42.01mm	2.087"/53.0mm
AMI-M12AL-8-20-B	3.2"/81.28mm	1.35"/34.29mm	1.18"/29.99mm	1.654"/42.01mm	2.087"/53.0mm

Typical Insertion Loss

According to CISPR17 in 50 Ω system

— Common Mode / Asymmetrical (L-G)
 — Differential Mode / Symmetrical (L-L)

